



VeriSens[®] Series 1200-IP 69K

Powerful vision sensors with IP 69K protection class

For inspection and acquisition of

- Part location
- Part orientation
- Part completeness
- Part presence

Sensor Solutions

Motion Control

Vision Technologies

Process Instrumentation

Series 1200-IP 69K

Models	VXR 1203M10WR	VXR 1203M16WR
Image sensor	High Sensitive Progressive Scan CCD	
Number of pixels	656 x 494	
Type	Monochrome	
LED illumination	White	
Speed	High Resolution Mode: max. 30 inspections per second High Speed Mode: max. 50 inspections per second	
Lens	f = 10 mm	f = 16 mm
Min. object distance	50 mm	60 mm
Object distance	Maximum field of view	
60 mm	30 mm x 23 mm	13 mm x 10 mm
100 mm	51 mm x 38 mm	26 mm x 20 mm
200 mm	101 mm x 76 mm	57 mm x 43 mm
300 mm	152 mm x 114 mm	89 mm x 67 mm
Signal processing	Baumer FEX® 3.0	
Processor	Baumer FEX® 3.0	
Memory	64 MBytes	
Inputs / Outputs	Inputs: 8...30 VDC / Outputs: PNP 100 mA	
4x digital input	Trigger	
	Job selection 1	
	Job selection 2	
	Job selection 3 / external Teach-in	
4x digital output	Ready	
	Pass / Fail	
	Alarm	
	Flash sync	
Communication		
Serial setup	USB 2.0	
Serial process interface	RS485	
Electrical data		
Power supply	8...30 VDC	
Power consumption	Typical 6 Watts	
Housing		
Material	Stainless steel 1.4404	
Material cover glass	Laminated safety glass Siplax VSG	
Weight	670 g	
Operating conditions		
Operating temperature	5 °C...50 °C	
Humidity	0 %...90 % (non-condensing)	
Protection class	IP 69K	

Your benefits

- Powerful vision sensors in stainless steel for direct use in demanding environmental conditions
- Easy and robust cleaning due to optimal housing design with protection class IP 69K
- Reliable operation even under varying lighting conditions due to contour-based image processor
- Rapid commissioning is supported by intuitive user interface with pre-configured sensor functions
- Capable of storing and switching between up to 255 jobs

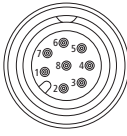
PLC interface	Type M12 / 8-pin
1: IN1 (Trigger)	
2: Power + 24 VDC	
3: OUT1 (Ready)	
4: OUT2 (Pass / Fail)	
5: OUT3 (Alarm)	
6: IN2 (Job)	
7: Ground	
8: IN3 (Job)	

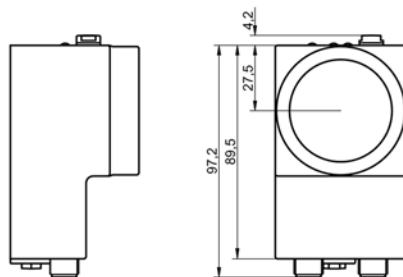

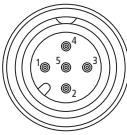
PLC interface	Type M12 / 5-pin
1: OUT4 (Flash)	
2: IN4 (Job / Teach)	
3: Ground	
4: RS485+	
5: RS485-	

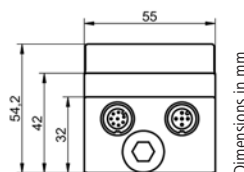

- Compact
- Reliable
- Powerful
- User-friendly



Baumer

Baumer Switzerland

Baumer Group · International Sales
P.O. Box · Hummelstrasse 17 · CH-8501 Frauenfeld
Phone +41 (0)52 728 1122 · Fax +41 (0)52 728 1144
sales@baumergroup.com · www.baumergroup.com

Find your local partner

www.baumergroup.com/worldwide